

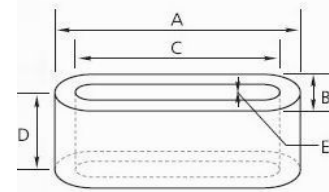

# Ferrite Cores

## HFS TYPE



NO	Specifications		Dimensions:mm					Impedance(Ω) min	
			A	B	C	D	E	25MHz	100MHz
1	HFS	5X3X3X9-1	5±0.3	3±0.3	3±0.3	9±0.4	1±0.3	40	95
2	HFS	5X3X3.4X9-1.4	5±0.3	3±0.3	3.4±0.3	9±0.4	1.4±0.3	30	85
3	HFS	5X3X3.4X4-1.4	5±0.3	3±0.3	3.4±0.3	4±0.3	1.4±0.3	20	65
4	HFS	6.5X3.8X4X5.5-1.5	6.5±0.4	3.8±0.4	4±0.4	5.5±0.4	1.5±0.4	20	70
5	HFS	6.5X3.8X4X9-1.5	6.5±0.4	3.8±0.4	4±0.4	9±0.4	1.5±0.4	65	85
6	HFS	7.5X5.5X5.3X8-3.3	7.5±0.5	5.5±0.5	5.3±0.5	8±0.5	3.3±0.5	25	75
7	HFS	7.5X5.5X5.3X11.5-3.3	7.5±0.5	5.5±0.5	5.3±0.5	11.5±0.5	3.3±0.5	30	85
8	HFS	8.5X5X6.2X3.4-1.3	8.5±0.5	5±0.5	6.2±0.5	3.4±0.4	1.3±0.4	20	60
9	HFS	9.1X5.6X7.2X5-3.7	9.1±0.5	5.6±0.5	7.2±0.5	5±0.5	3.7±0.5	20	65
10	HFS	9.1X5.6X7.2X7.8-3.7	9.1±0.5	5.6±0.5	7.2±0.5	7.8±0.5	3.7±0.5	20	70
11	HFS	12X4.5X9X12-1.5	12±0.5	4.5±0.5	9±0.5	12±0.5	1.5±0.5	45	115
12	HFS	19X6.5X14X8-1.7	19±0.6	6.5±0.5	14±0.6	8±0.5	1.7±0.5	25	75
13	HFS	19X6.5X14X8-2.0	19±0.6	6.5±0.5	14±0.6	8±0.5	2±0.5	25	75
14	HFS	19X6.5X14.5X12-2.5	19±0.6	6.5±0.5	14.5±0.6	12±0.5	2±0.5	30	85
15	HFS	19X6.5X13.5X12-1.8	19±0.6	6.5±0.5	13.5±0.6	12±0.5	1.8±0.5	40	100
16	HFS	19X6.5X14X12-1.8	19±0.6	6.5±0.5	14±0.6	12±0.5	1.8±0.5	40	100
17	HFS	23.5X6.5X18.5X12.5-1.5	23.5±0.6	6.5±0.5	18.5±0.6	12.5±0.5	1.5±0.5	40	110
18	HFS	23.5X6.5X18.5X15-1.1	23.5±0.6	6.5±0.5	18.5±0.6	15±0.5	1.1±0.5	45	120
19	HFS	23.5X6.5X19.5X15-1.4	23.5±0.6	6.5±0.5	19.5±0.6	15±0.5	1.4±0.5	40	115
20	HFS	25X5X21X9.5-1.5	25±0.6	5±0.5	21±0.6	9.5±0.5	1.5±0.5	25	95
21	HFS	25X5X21X12-1.5	25±0.6	5±0.5	21±0.6	12±0.5	1.5±0.5	30	100
22	HFS	28X8X21X15-2	28±0.7	8±0.5	21±0.6	15±0.5	2±0.5	40	110
23	HFS	28X7.7X23X12-2.4	28±0.7	7.7±0.5	23±0.6	12±0.5	2.4±0.5	35	100
24	HFS	28X14X20.5X13-7.2	28±0.7	14±0.5	20.5±0.6	13±0.5	7.2±0.5	30	90
25	HFS	29X8X22X10-2	29±0.7	8±0.5	22±0.6	10±0.5	2±0.5	30	95
26	HFS	29X8X22X12-2.4	29±0.7	8±0.5	22±0.6	12±0.5	2.4±0.5	30	115
27	HFS	32X6.5X28.5X9.5-2.5	32±1.0	6.5±0.5	28.5±0.6	9.5±0.5	2.5±0.5	20	80
28	HFS	32X6.5X27.5X9.5-3.0	32±1.0	6.5±0.5	27.5±0.6	9.5±0.5	3±0.5	20	80
29	HFS	32X6.5X28X12-2.5	32±1.0	6.5±0.5	28±0.6	12±0.5	2.5±0.5	20	85
30	HFS	33.5X6.5X27.5X8-1.5	33.5±1.0	6.5±0.5	27.5±0.6	8±0.5	1.5±0.5	20	80
31	HFS	33.5X6.5X27.5X10-1.8	33.5±1.0	6.5±0.5	27.5±0.6	10±0.5	1.8±0.5	30	95
32	HFS	33.5X6.5X27.5X12-1.8	33.5±1.0	6.5±0.5	27.5±0.6	12±0.5	1.8±0.5	35	100

The data is reference only. Customers should verify actual device performance in their specific applications. Specifications are subject to change without notice. Please check our website for latest information.  
<http://www.ftind.com>



# Ferrite Cores

## HFS TYPE

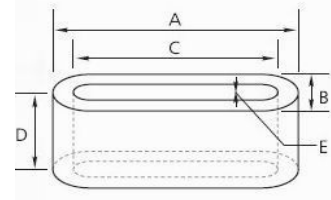

NO	Specifications		Dimensions:mm					Impedance( $\Omega$ ) min	
			A	B	C	D	E	25MHz	100MHz
33	HFS	33.5X6.5X27X8-1.3	33.5 $\pm$ 1.0	6.5 $\pm$ 0.5	27 $\pm$ 0.6	8 $\pm$ 0.5	1.3 $\pm$ 0.5	25	85
34	HFS	33.5X6.5X27X10-1.3	33.5 $\pm$ 1.0	6.5 $\pm$ 0.5	27 $\pm$ 0.6	10 $\pm$ 0.5	1.3 $\pm$ 0.5	30	105
35	HFS	33.5X6.5X27X12-1.3	33.5 $\pm$ 1.0	6.5 $\pm$ 0.5	27 $\pm$ 0.6	12 $\pm$ 0.5	1.3 $\pm$ 0.5	30	110
36	HFS	33.5X6.5X27X15-1.3	33.5 $\pm$ 1.0	6.5 $\pm$ 0.5	27 $\pm$ 0.6	15 $\pm$ 0.5	1.3 $\pm$ 0.5	40	120
37	HFS	38.5X4X35X12-0.8	38.5 $\pm$ 1.5	4 $\pm$ 0.4	35 $\pm$ 1	12 $\pm$ 0.5	0.8 $\pm$ 0.4	35	115
38	HFS	38.5X4X35X18-0.8	38.5 $\pm$ 1.5	4 $\pm$ 0.4	35 $\pm$ 1	18 $\pm$ 0.6	0.8 $\pm$ 0.4	50	150
39	HFS	40X6.5X35X12-1.8	40 $\pm$ 1.5	6.5 $\pm$ 0.5	35 $\pm$ 1	12 $\pm$ 0.5	1.8 $\pm$ 0.5	30	110
40	HFS	40X6.5X35X15-2	40 $\pm$ 1.5	6.5 $\pm$ 0.5	35 $\pm$ 1	15 $\pm$ 0.5	2 $\pm$ 0.5	30	100
41	HFS	40X6.5X35X18-2	40 $\pm$ 1.5	6.5 $\pm$ 0.5	35 $\pm$ 1	18 $\pm$ 0.5	2 $\pm$ 0.5	40	125
42	HFS	49.6 X 6.5X44X12-1.3	49.6 $\pm$ 1.5	6.5 $\pm$ 0.5	44 $\pm$ 1	12 $\pm$ 0.5	1.3 $\pm$ 0.5	20	65

The data is reference only. Customers should verify actual device performance in their specific applications. Specifications are subject to change without notice. Please check our website for latest information.  
<http://www.ftind.com>